

- 1 Leg
- 2 Base frame
- 5 Side panel — right
- 6 Side panel — left
- 8 Door frame
- 9 Front panel
- 30 Ring for handle
- 31 Plastic handgrip

- 12 Flue spigot
- 13 Damper butterfly
- 15 Washer
- 16 Split pin
- 23 Handle
- 35 Spring
- 69 Flue outlet complete

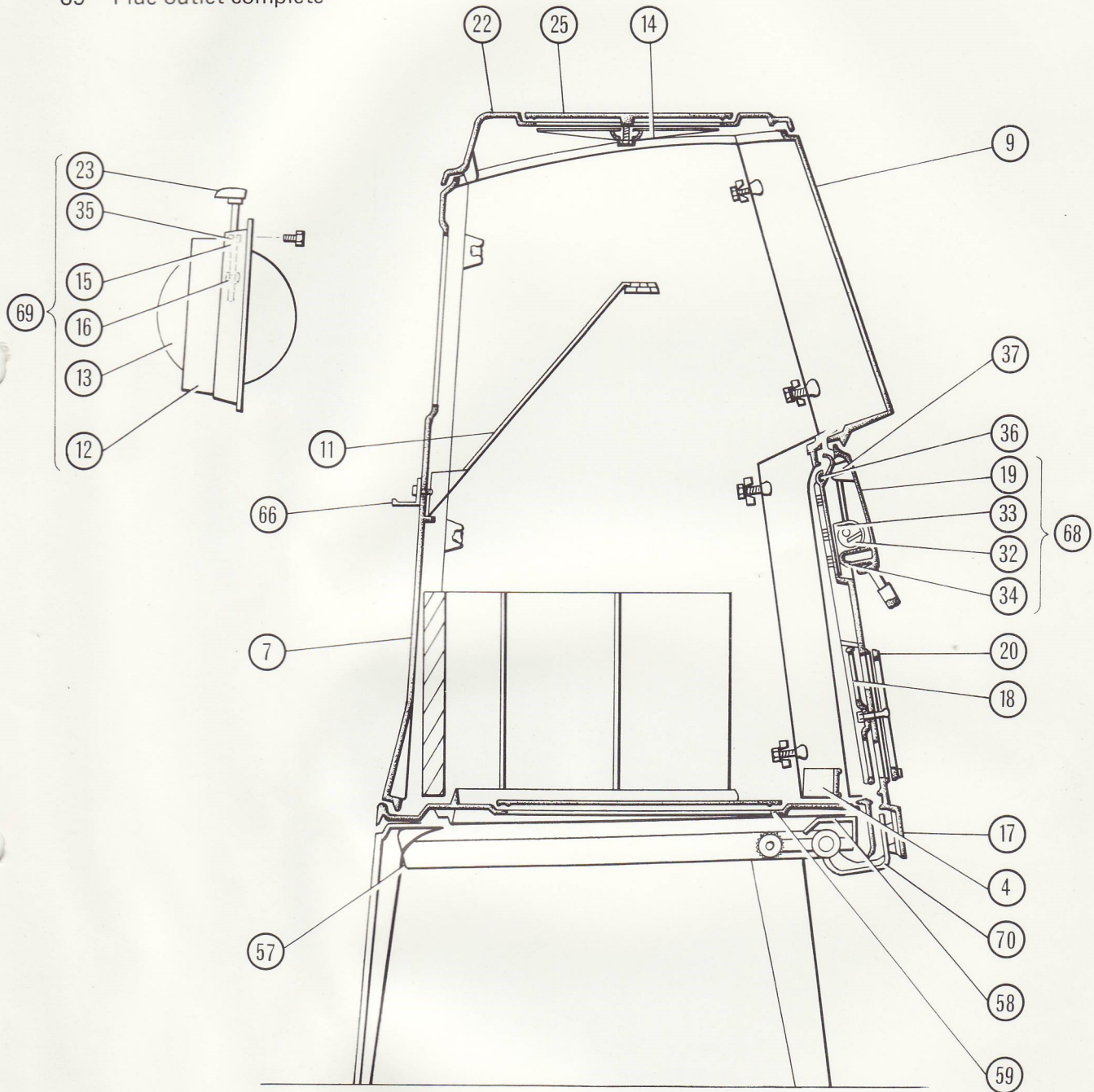

- |                          |                            |
|--------------------------|----------------------------|
| 4 Ash rail               | 32 Cylinder                |
| 7 Back panel             | 33 Cylinder bracket        |
| 9 Front panel            | 34 Latch spring            |
| 11 Baffle (Throat plate) | 36 Door catch              |
| 14 Locking bar           | 37 Steel ball              |
| 17 Door                  | 57 Spring stop             |
| 18 Air grill             | 58 Spring heat shield      |
| 19 Latch                 | 59 Rail heat shield        |
| 20 Air control           | 66 Spark guard hook        |
| 22 Top frame             | 68 Latch complete          |
| 25 Blanking plate        | 70 Door mechanism complete |



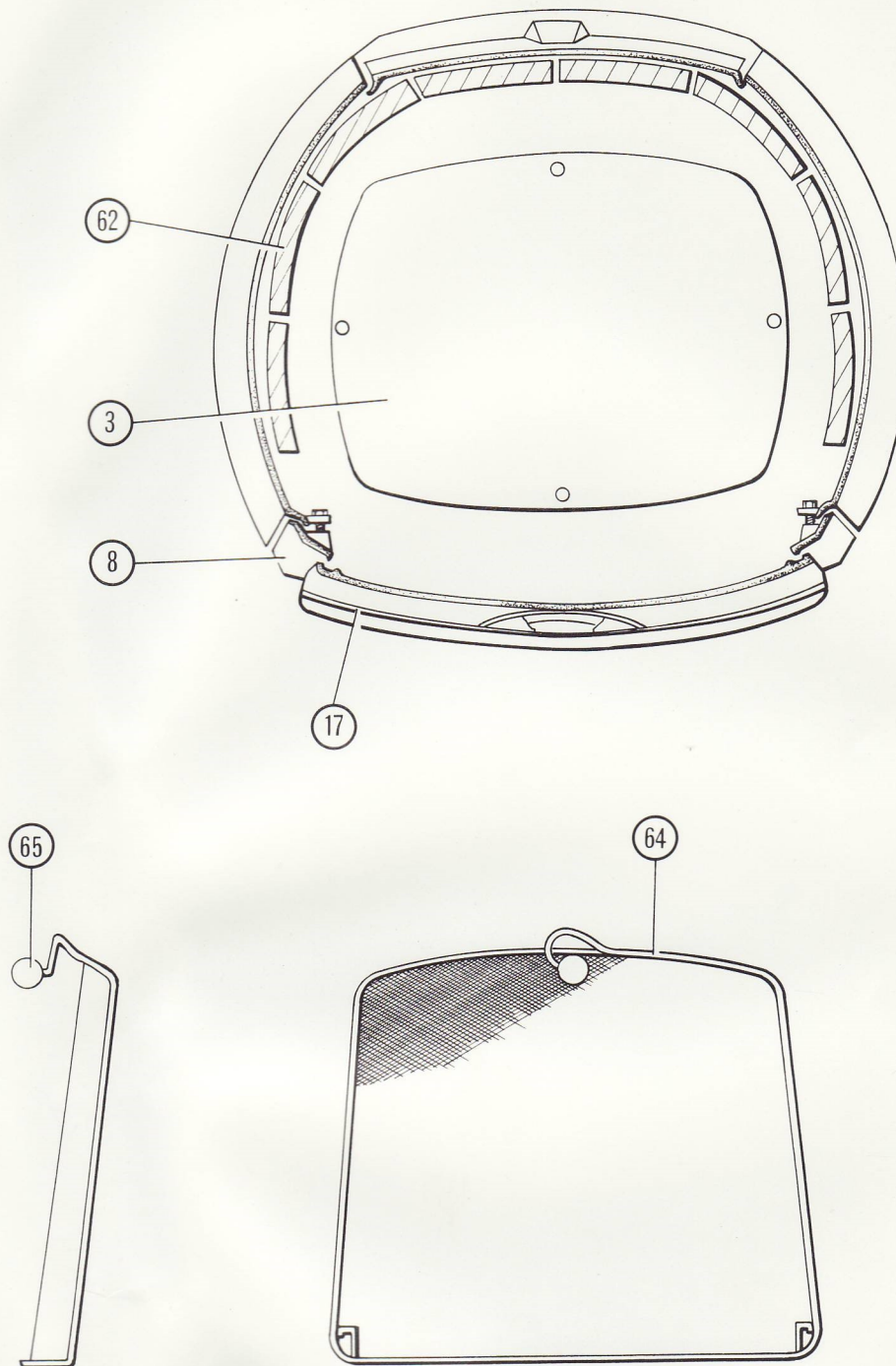

- 3 Hearth plate
- 8 Door frame
- 17 Door
- 62 Firebrick
- 64 Spark guard
- 65 Plastic ball

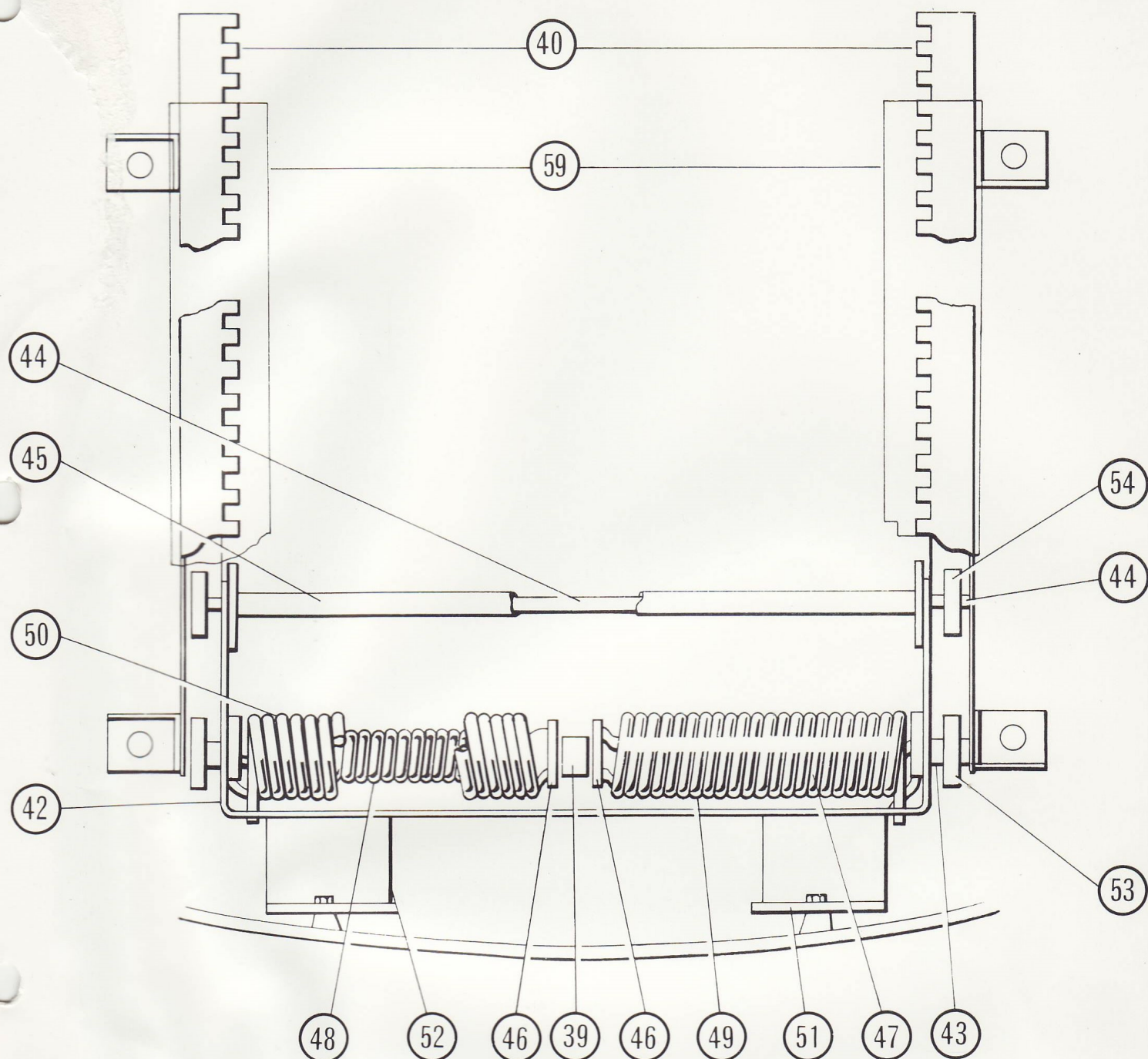

- 70 Complete spring mechanism  
(does not include rails or heat shields)
- 39 Spring mechanism clip
- 40 Rail
- 42 Connecting rod
- 43 Axle 10mm
- 44 Axle 7mm
- 45 Axle tube with cogs
- 46 Connector
- 47 Coil spring 23mm
- 48 Coil spring 23mm
- 49/50 Coil springs 37mm
- 51 Hinge
- 52 Hinge
- 53 Roller 10mm
- 54 Roller 7mm
- 59 Heat shield