





















Scan 68

			
Scan 68-1 BP: 30047666+51052062 GP: 30047690+51052296 GWH: 30047682+51050353 CHA: 30047704+51052302 SIL: 30047712+51052307	Scan 68-2 BP: 30047667+51052062 GP: 30047691+51052296 GWH: 30047683+51050353 CHA: 30047705+51052302 SIL: 30047713+51052307	Scan 68-3 BP: 30047666+51052060 GP: 30047690+51052297 GWH: 30047682+51050350 CHA: 30047704+51052303 SIL: 30047712+51052308	Scan 68-4 BP: 30047667+51052060 GP: 30047691+51052297 GWH: 30047683+51050350 CHA: 30047705+51052303 SIL: 30047713+51052308
			
Scan 68-5 BP: 30047666+51052061 GP: 30047690+51052298 GWH: 30047682+51050351 CHA: 30047704+51052304 SIL: 30047712+51052309	Scan 68-6 BP: 30047667+51052061 GP: 30047691+51052298 GWH: 30047683+51050351 CHA: 30047705+51052304 SIL: 30047713+51052309	Scan 68-7 BP: 30047668+51052062 GP: 30047692+51052296 GWH: 30047684+51050353 CHA: 30047706+51052302 SIL: 30047714+51052307	Scan 68-8 BP: 30047669+51052062 GP: 30047693+51052296 GWH: 30047685+51050353 CHA: 30047707+51052302 SIL: 30047715+51052307
			
Scan 68-9 BP: 30047668+51052060 GP: 30047692+51052297 GWH: 30047684+51050350 CHA: 30047706+51052303 SIL: 30047714+51052308	Scan 68-10 BP: 30047669+51052060 GP: 30047693+51052297 GWH: 30047685+51050350 CHA: 30047707+51052303 SIL: 30047715+51052308	Scan 68-11 BP: 30047668+51052061 GP: 30047692+51052298 GWH: 30047684+51050351 CHA: 30047706+51052304 SIL: 30047714+51052309	Scan 68-12 BP: 30047669+51052061 GP: 30047693+51052298 GWH: 30047685+51050351 CHA: 30047707+51052304 SIL: 30047715+51052309
			
Scan 68-13 + High Top BP: 30047670 + 51052064 GP: 30047694 + 51052300 GWH: 30047686+51050354 CHA: 30047708+51052306 SIL: 30047716+5105311	Scan 68-14 + High Top BP: 30047671 + 51052064 GP: 30047695 + 51052300 GWH: 30047687+51050354 CHA: 30047709+51052306 SIL: 30047717+51052311	Scan 68-13 Low Base BP: 30052030 GP: 30047702 GWH: 30052032 CHA: 30047710 SIL: 30047718	Scan 68-14 Low Base BP: 30052031 GP: 30047703 GWH: 30052033 CHA: 30047711 SIL: 30047719
			
Scan 68-15 BP: 30047672+51047718 GP: 30047700+51004718 + top plate 50005095 or 96 High Top: 51052065 (BP)/51052301 (GP) + 51047719	Scan 68-16 BP: 30047673+51047718 GP: 30047701+51047718 + top plate 50005095 or 96 High Top: 51052065 (BP)/51052301 (GP) + 51047719	Scan 68-15 Low Base BP: 30047696+51052327 GP: 30047698+51052327 + top plate 50005095 or 96	Scan 68-16 Low Base BP: 30047697+51052327 GP: 30047699+51052327 + top plate 50005095 or 96

Doors for portal: 51052063 (BP) / 51052299 (GP) / 51050352 (GWH) / 51052305 (CHA) / 51052310 (SIL)

Exploded View Scan 68

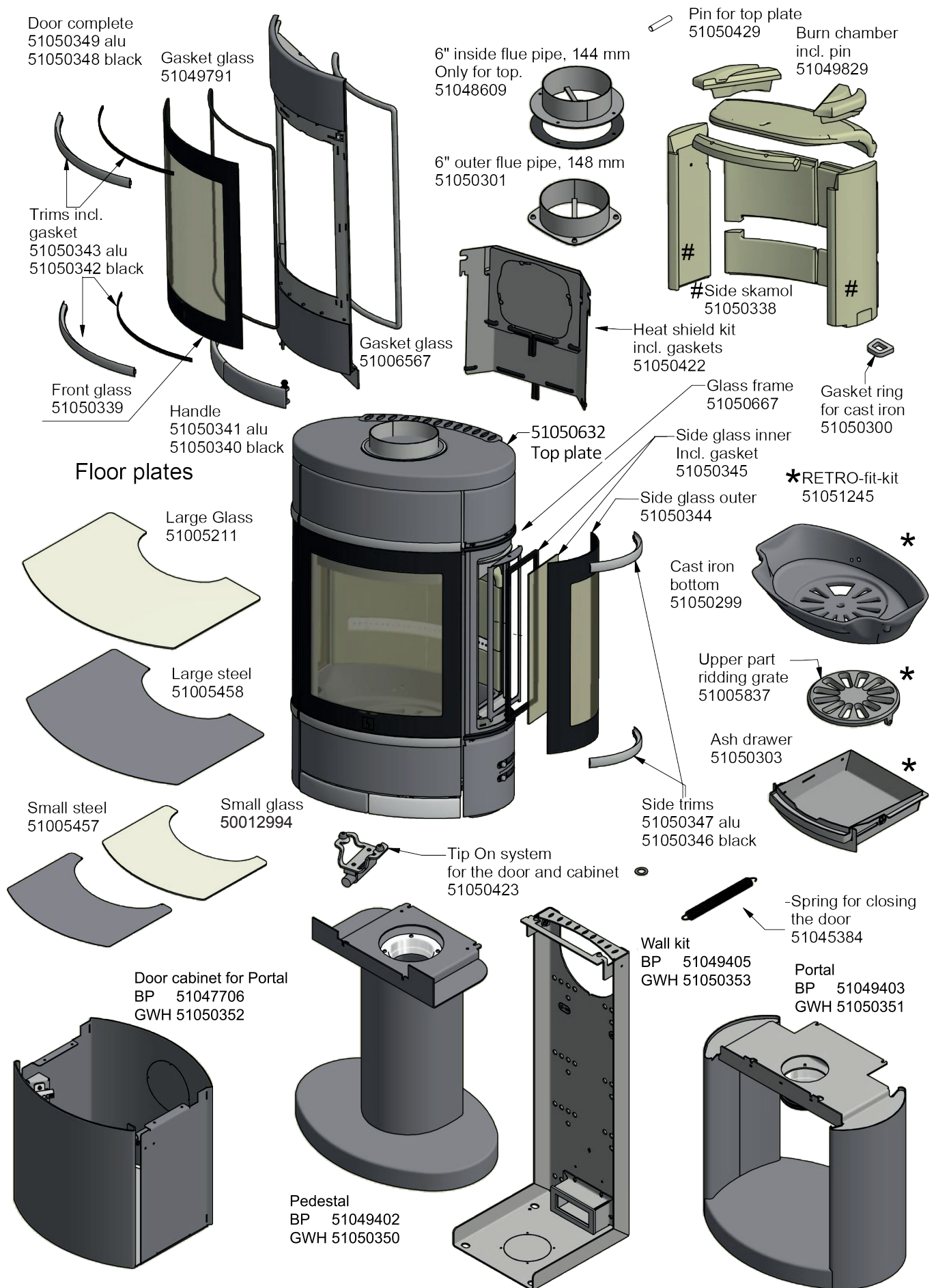

Exploded View Scan 68-13/14

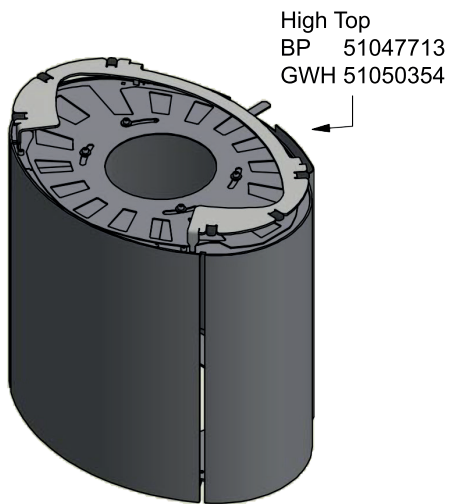

51050507
Side mantle left



51050508
Rear mantle

51050506
Side mantle right



50009418
Heat storage stones

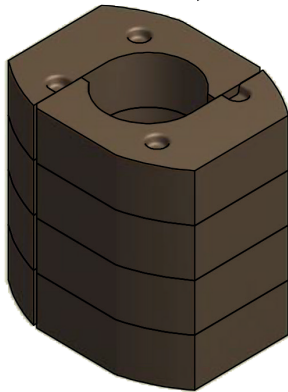

51050504
Front door



51037699
Wall mounting kit

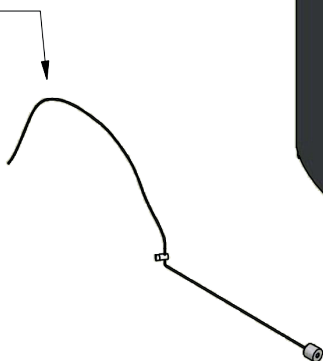

Exploded View Scan 68-15/16

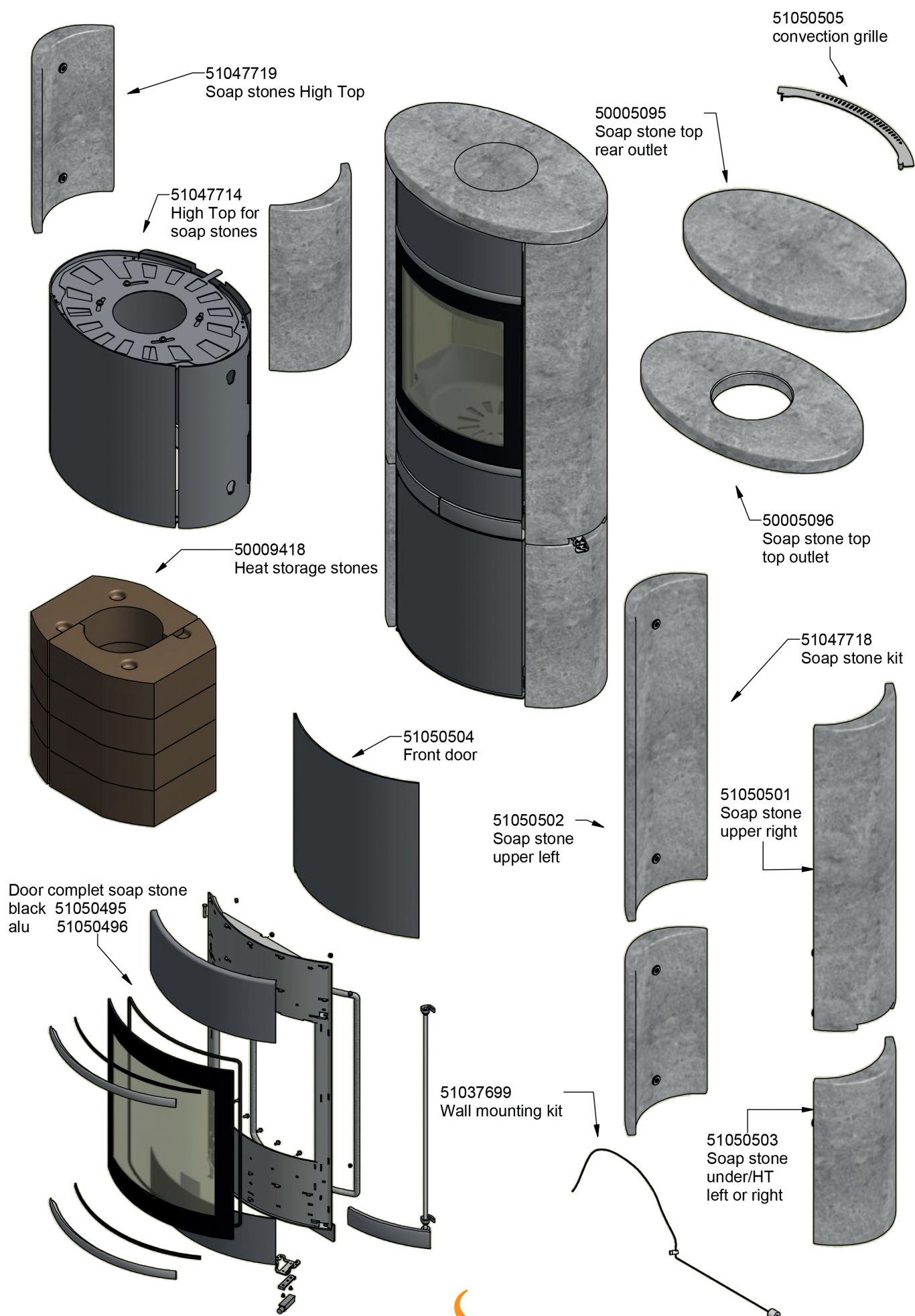

Scan 68-13/14

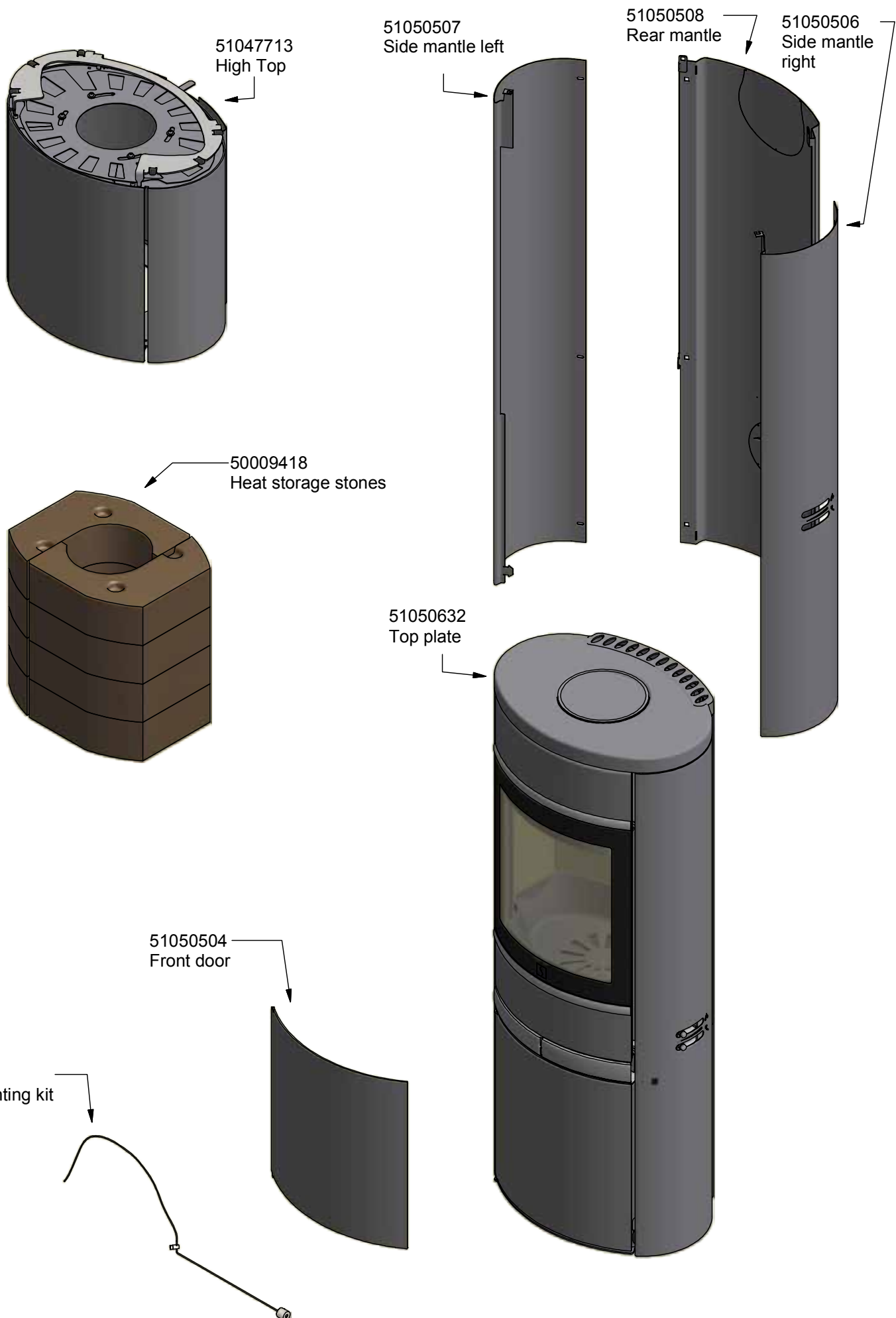

Scan 68-15/16

